



# TTX22M Coil Shock

Version 1.0, 13.06.2019, Öhlins DTC

Öhlins is offering the TTX22M Coil Shock in three different designs. “Side-by-Side”, “Universal” and “Trunnion”. This is because there are so many different bike brands and bike models out there, that it is almost impossible to have one design that fits all MTB frames.

Here you will find an overview of the different designs, the length and the part numbers.

## Cylinder head side-by-side

The side-by-side design gives you some more space in the frame for example a water bottle in an Enduro or trail bike. It comes in all imperial length and the new metric sizes.

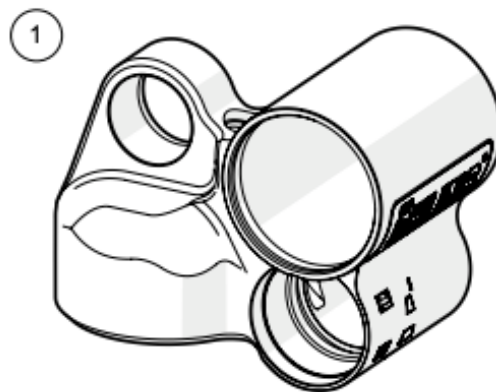



ADVANCED SUSPENSION TECHNOLOGY

## PRODUCT INFORMATION



length in inch	length in mm	part no.
7.5x2.0"	190x51	MTB 1498
7.87x2.0"	200x51	MTB 1497
7.87x2.25"	200x57	MTB 1496
8.5x2.5"	216x63	MTB 1491
8.75x2.75"	222x70	MTB 1492
9.5x3"	240x76	MTB 1493
10.5x3.5"	267x89	MTB 1494
metric	210x50	MTBM 1892
metric	210x55	MTBM 1893
metric	230x57,5	MTBM 1894
metric	230x60	MTBM 1895
metric	230x65	MTBM 1896
metric	250x70	MTBM 1898
metric	250x75	MTBM 1899

## Cylinder head universal

The universal design is build a little bit slimmer than the side-by-side design and fit frames that are narrow where the shock is mounted.



length in inch	length in mm	part no.
7.5x2.0"	190x51	MTB 1698
7.87x2.0"	200x51	MTB 1697
7.87x2.25"	200x57	MTB 1696
8.5x2.5"	216x63	MTB 1691
8.75x2.75"	222x70	MTB 1692
9.5x3"	240x76	MTB 1693
10.5x3.5"	267x89	MTB 1694

## Cylinder head Trunnion

The Trunnion design is specially build for frames that use a trunnion mounting for the shock.

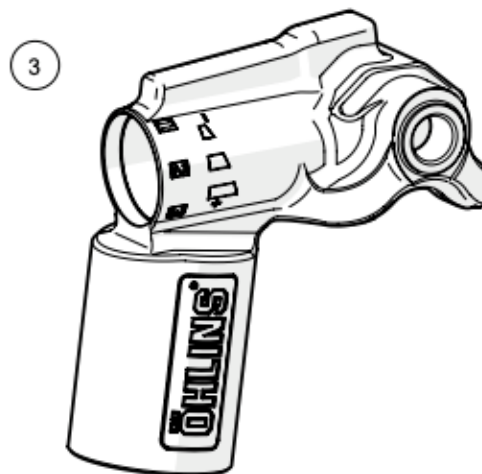

length in inch	length in mm	part no.
Trunnion	225x70	MTBM 1940
Trunnion	225x75	MTBM 1942
Trunnion	165x45	MTBM 1972
Trunnion	185x55	MTBM 1975
Trunnion	205x65	MTBM 1979